

FITTING **PMF** Bulkhead Female Straight

RoHS compliant

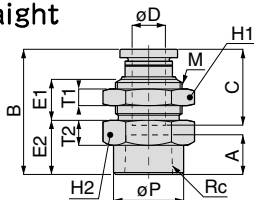

Unit : mm

Model code	Tube O.D. ϕD	Rc	M	B	E1	E2	A	Tube end C	ϕP	Hex. H1	Hex. H2	T1	T2	Orifice bore (ϕ mm)	Weight (g)	CAD file name
PMF4-01 ④	4	Rc1/8	M12 × 1	24.2	9	9	7	14.9	13.8	14	14	4	5	3	17	PMF4-01_
PMF4-02 ④		Rc1/4		27.5		12.3	9.5		16.8		17		6		22	PMF4-02_
PMF6-01 ④	6	Rc1/8	M14 × 1	26.4	10.2	10	7	17	13.8	17	17	4	6	5	25	PMF6-01_
PMF6-02 ④		Rc1/4		28.7		12.3	9.5		16.8		19		26		PMF6-02_	
PMF6-03 ④		Rc3/8		30.4		14	10.5		19.5						29	PMF6-03_
PMF8-01 ④	8	Rc1/8	M16 × 1	27	9.8	10	7	18.2	13.8	19	19	4	6	7	30	PMF8-01_
PMF8-02 ④		Rc1/4		30		13	9.5		16.8		32		PMF8-02_			
PMF8-03 ④		Rc3/8		31		14	10.5		19.5						30	PMF8-03_
PMF10-02 ④	10	Rc1/4	M20 × 1	32.7	11.1	13	9.5	20.7	16.8	24	24	5	7	9	55	PMF10-02_
PMF10-03 ④		Rc3/8		33.7		14	10.5		20.8		56		PMF10-03_			
PMF12-02 ④	12	Rc1/4	M22 × 1	35.3	12.4	13	9.5	23.3	16.8	27	24	6	7	11	65	PMF12-02_
PMF12-03 ④		Rc3/8		36.3		14	10.5		20.8		PMF12-03_					
PMF12-04 ④		Rc1/2		39.3		17	13		25						67	PMF12-04_
PMF16-03 ④	16	Rc3/8	M27 × 1.5	38.3	14.4	14	10.5	24.8	20.8	32	29	9	8.5	14.2	110	PMF16-03_
PMF16-04 ④		Rc1/2		40.8		16.5	13		25		15		PMF16-04_			

※ 1. ④ in Model code / Replaced with "W" for Light-gray color, "-C" for Clean-room package, "W-C" for Light-gray color and Clean-room package, "-UC" for Clean-wash and Clean-room package

※ 2. Orifice bore is the smallest passage converted in terms of the diameter.