

100 Series Pneumatic Angle Seat Valve



100 Series Pneumatic Angle Seat Valve

△ Pressure Data Sheet

Single Acting, Normally Closed (NC) - Enter Above Seat

Suitable for condensable media, such as air, steam and low pressure liquid media.

Size	Thread End	Orifice (mm)	Kv(m ³ /h)	Actuator (mm)	Pressure (psi)	Control Pressure (psi)
DN10	3/8"	13	3.8	40	232	43 - 65
				50	232	43 - 50
DN15	1/2"	13	4.7	40	232	43 - 65
				50	232	43 - 50
DN20	3/4"	18	9.5	50	232	43 - 58
DN25	1"	24	18.1	50	232	43 - 65
				63	232	43 - 50
DN32	1-1/4"	31	23.1	63	232	43 - 80
				90	232	36 - 50
DN40	1-1/2"	35	32.9	63	232	43 - 94
				90	232	36 - 58
DN50	2"	45	52.8	63	145	43 - 101
				90	232	36 - 65
DN65	2-1/2"	61	82.6	90	145	36 - 87
				125	232	43 - 58
DN80	3"	80	127	125	232	43 - 101

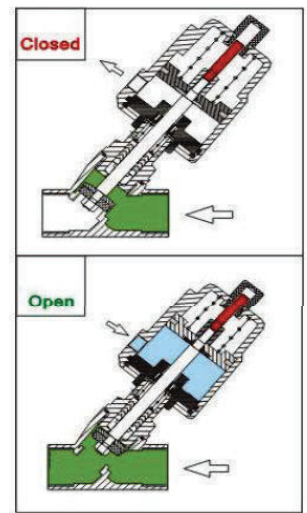

Single Acting, Normally Closed (NC) - Enter Below Seat (No Water-Hammer)

Flow comes from below the seat, cushions closing and eliminates water hammer.

Size	Thread End	Orifice (mm)	Kv(m ³ /h)	Actuator (mm)	Pressure (psi)	Control Pressure (psi)
DN10	3/8"	13	3.8	40	159	43
				50	203	43
DN15	1/2"	13	4.7	40	159	43
				50	203	43
DN20	3/4"	18	9.5	50	203	43
DN25	1"	24	18.1	50	58	43
				63	203	56
				90	232	72.5
DN32	1-1/4"	31	23.1	63	87	65
				90	232	72.5
DN40	1-1/2"	35	32.9	63	72	65
				90	232	72.5
DN50	2"	45	52.8	90	145	72.5
DN65	2-1/2"	61	82.6	90	101	72.5
				125	130	87
DN80	3"	80	127	125	87	87

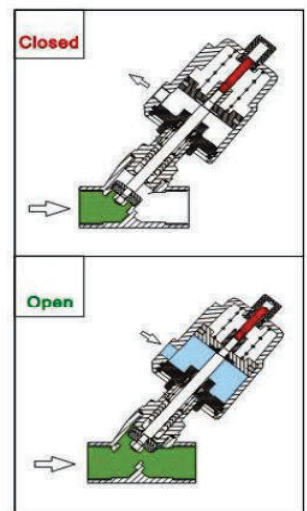

100 Series Pneumatic Angle Seat Valve

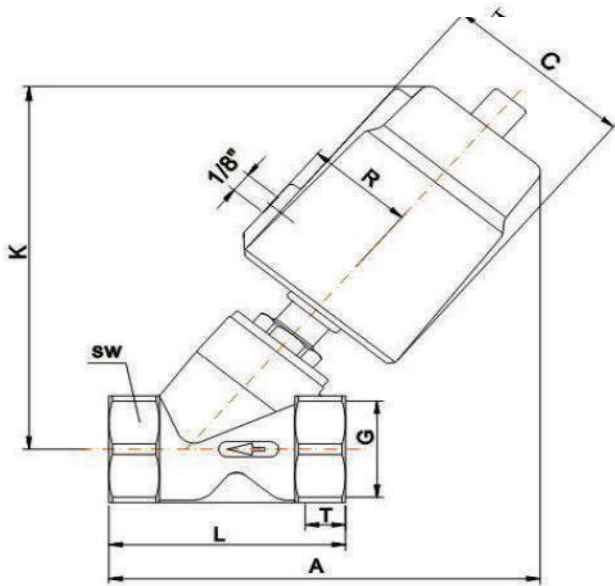

Threaded Connection

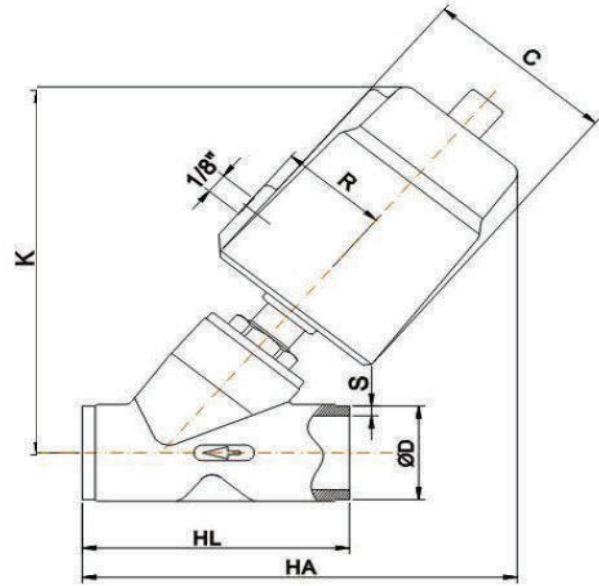

Welded Connection

Dimensions

Size	Actuator (mm)	C	R	K	Threaded Connection					Welded Connection										
					G	T	A	L	SW	DIN11850-2			DIN11850-3		SMS3008					
										HA	HL	D	S	D	S	HA	HL	D	S	
DN10	40	50.5	27	211	3/8"	12	119	68	27	—	—	—	—	—	—	—	—	—	—	—
	50	60	33	124			131			—	—	—	—	—	—	—	—	—	—	—
DN15	40	50.5	27	111	1/2"	15	119	68	27	118	70	19	1.5	20	2	127	75	18	1	—
	50	60	33	124			131			128						138				
DN20	50	60	33	128	3/4"	16	136	75	32	135	82	23	1.5	24	2	145	95	25	1.2	—
DN25	50	60	33	136	1"	17	145	90	40	150	100	29	1.5	30	2	165	130	32	1.2	—
	63	75	41	162			175			188										
	90AL	112	57	210			211			230										
	90	106	55	211			213			232										
DN32	63	75	41	174	1-1/4"	21	187	116	50	186	125	35	1.5	36	2	200	145	33.7	1.2	—
	90AL	112	57	220			229			242										
	90	106	55	223			231			245										
DN40	63	75	41	175	1-1/2"	21	187	116	56	190	130	41	1.5	42	2	210	160	38	1.2	—
	90AL	112	57	220			230			252										
	90	106	55	223			231			255										
DN50	63	75	41	183	2"	22	201	138	69	206	155	53	1.5	54	2	224	175	51	1.2	—
	90AL	112	57	232			244			263										
	90	106	55	232			247			265										
DN65	90AL	112	57	262	2-1/2"	26	282	178	85	—	—	—	—	—	—	—	—	—	—	—
	90	106	55	265			285			—										
	125AL	148	74	302			320			—										
DN80	125AL	148	74	313	3"	27	372	210	100	—	—	—	—	—	—	—	—	—	—	—