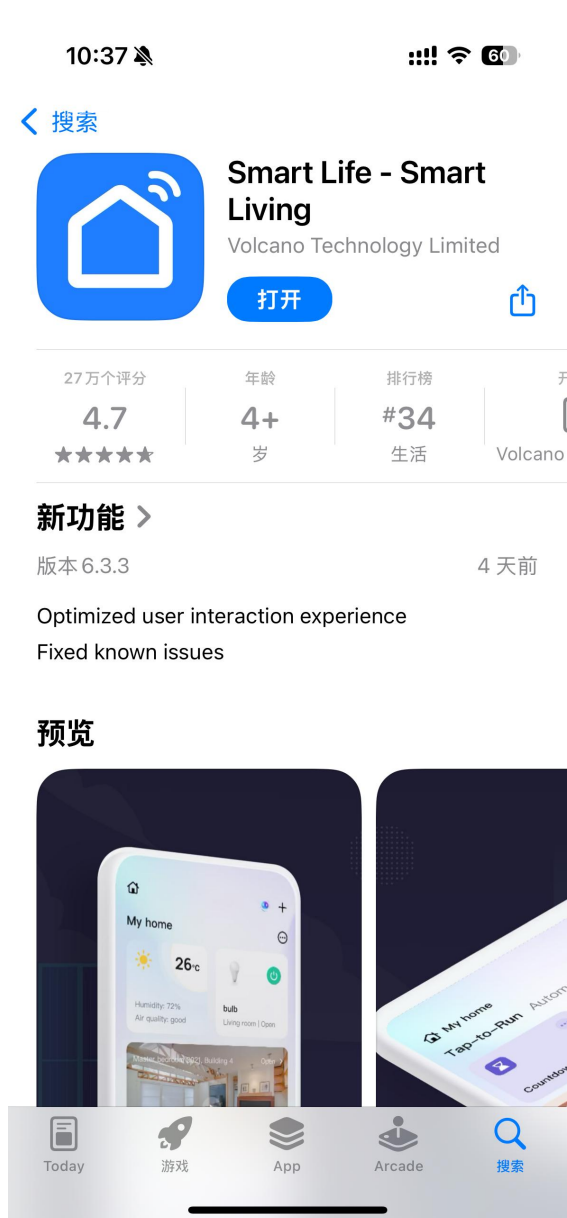

**Technical Parameters:**

Product Size	DN8/DN10/DN15/DN20/DN25 (NPT/BSP 2way valve) DN8/DN10/DN15/DN20/DN25 (NPT/BSP 3way brass valve)
Maximum Working Pressure	1.0MPa
Circulation Medium	Fluid,Air
Working Voltage	DC5V
Working Current	≤500mA
Valve Body Material	Brass, SS304, SS316, Nickel plated brass
Open/Close Time	≤10S
Life Time	70000 Times
Actuator Material	Engineering plastic
Torque Force	3 N.m
Environment Temperature	-15℃~50℃
Liquid Temperature	2℃~90℃
Manual Override	No
Open/Close Indicator	Yes
Line Control Method	WIFI "Smart Life" APP
Pedestal	PTFE
Sealing Material	FKM/EPDM (Optional)
Protection Class	IP67
Company management system	ISO 9001:2015

## Instructions:

### Step 1:

Download “Smart Life”APP from the App Store or Google Play.Sign up and log in.



### Step 2:

Click the + sign in the upper right corner to add a device.

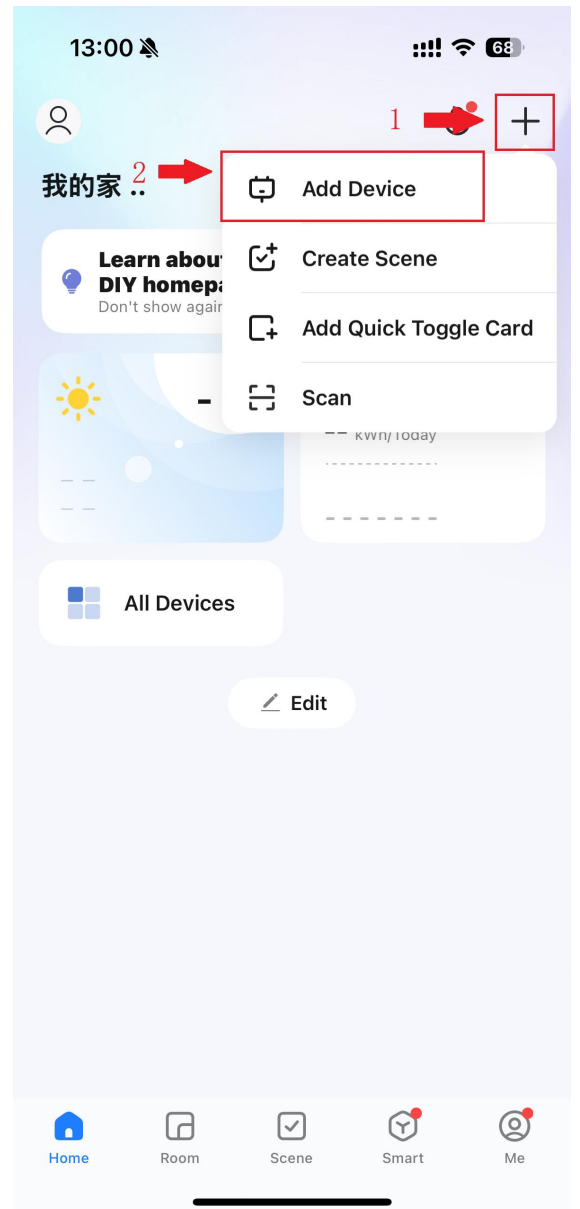

### Step 3:

WIFI Electric valve connected to power supply.

Press and hold the button for 5 seconds until the yellow indicator light flashes, and the electric valve enters the distribution network state.

### Step 4:

Click Radio Valve Controller.

Choose Wi-Fi and enter password,device added successfully

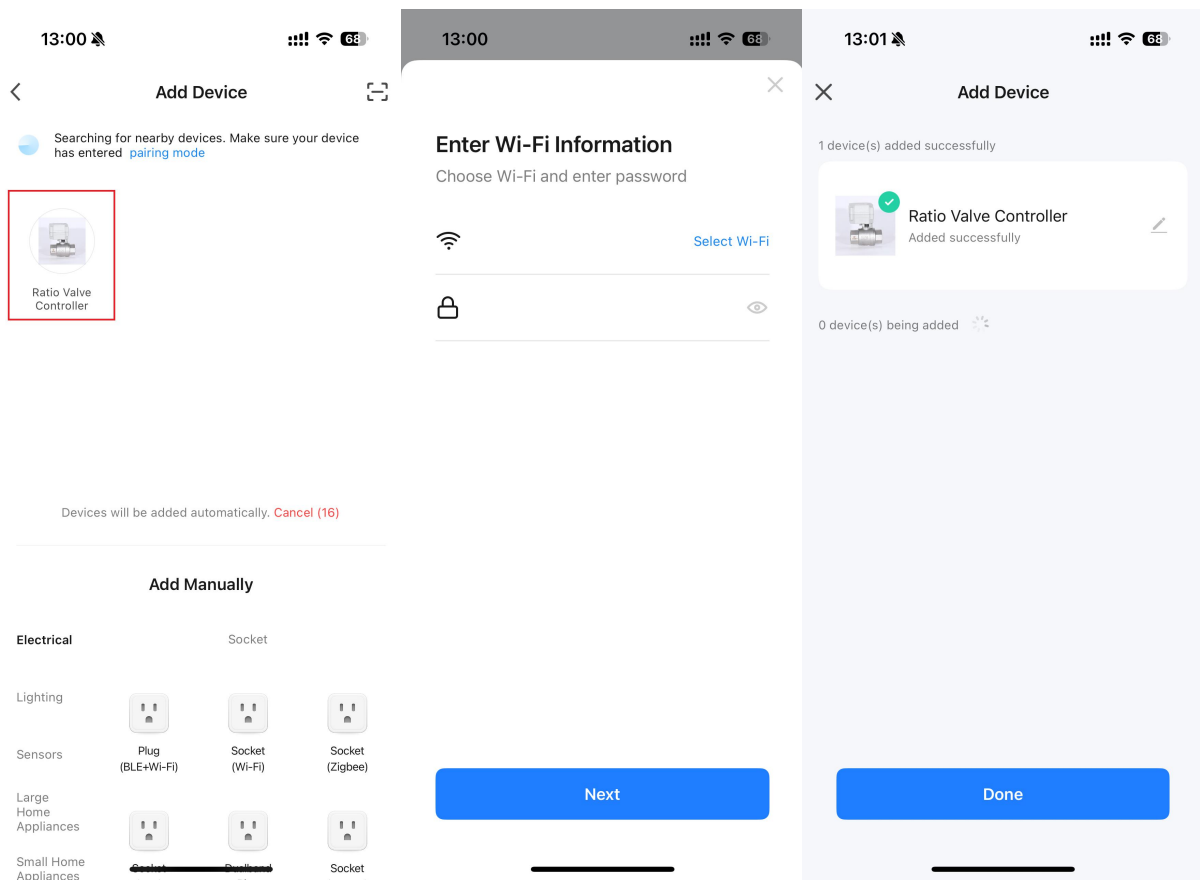

## Step 5:

On the homepage, click “Ratio Valve Controller” to enter the parameter setting page. Click button “0%” to fully off the valve; Click button “100%” to fully open the valve. The middle instrument panel controls the valve opening from 0 to 100%, with each scale representing 10% of the valve opening.

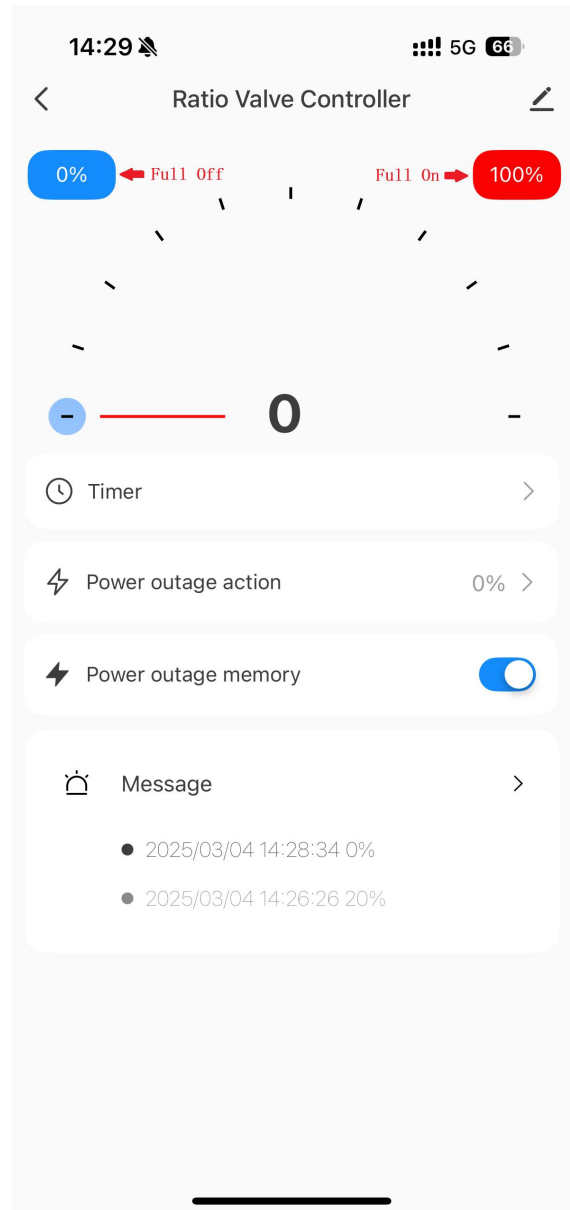
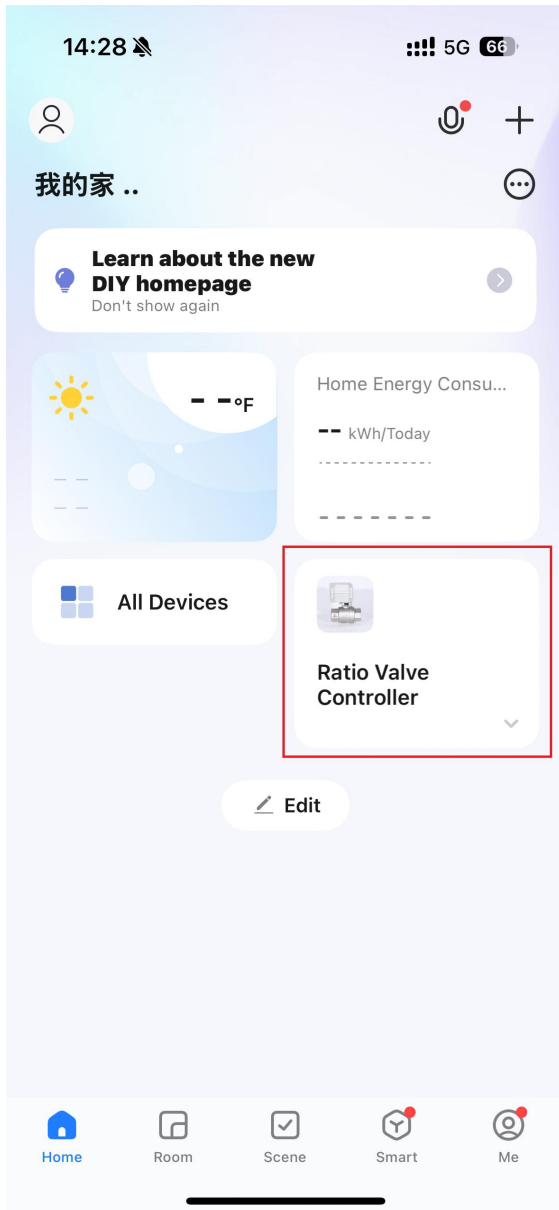

## Timer:

You can set a time point in the day to open the valve to a fixed valve opening.

For example, if you set the time: 8:30 and Repeat: Friday and Percent: 50%, the valve will open 50% at 8:30 every Friday.

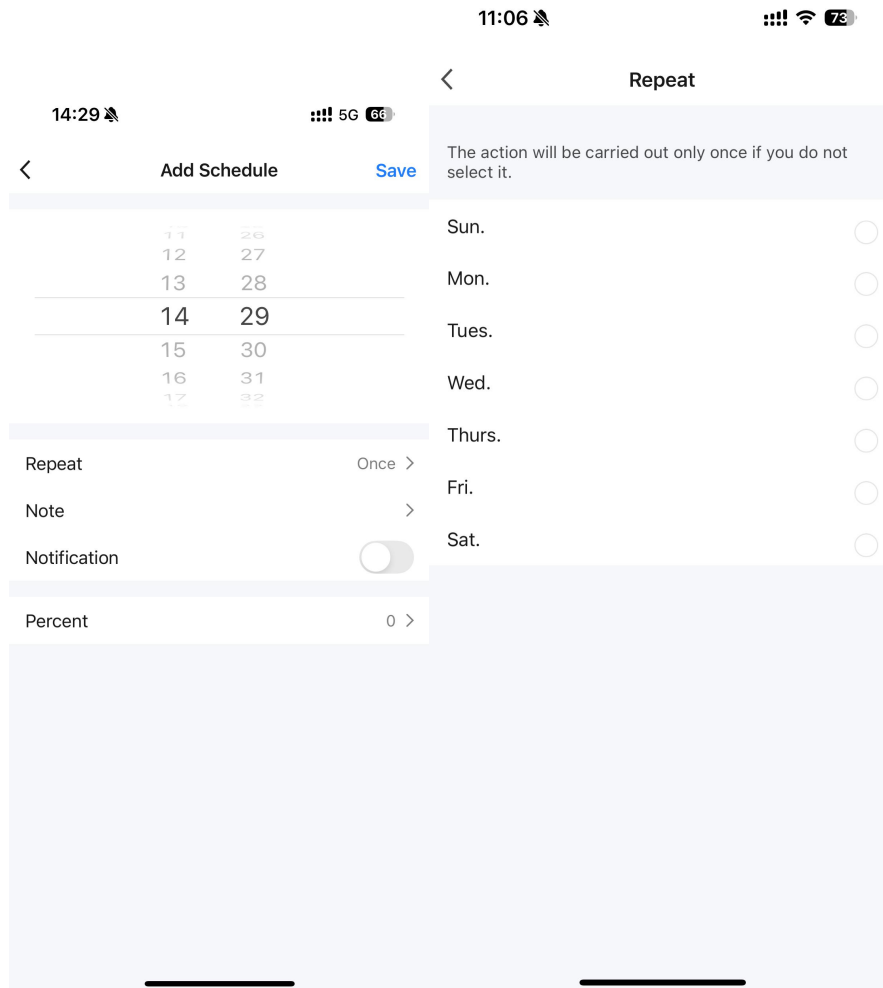

## Power outage memory:

Under the premise of “Power outage memory” function being turned on, set “Power outage action” where the valve stops after power failure. 0% means the valve is completely closed after power failure. 100% means the valve is completely open after power failure.

